

TORQUE TRANSMITTER

Torque load cell

1. Product description

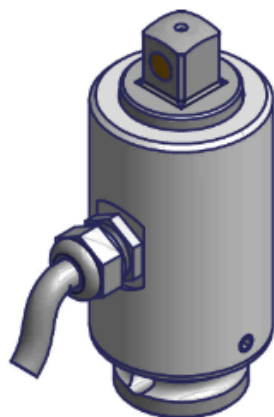

- 1 Capacities from 1 Nm to 5000 Nm
- 2 Load cell and safe-keeping in aluminium construction (1-10 Nm)
Load cell in steel and safe-keeping in aluminium construction (20-5000 Nm)
- 3 Protection IP64 (EN 60529)
- 4 High accuracy
- 5 On request ATEX zona 22 version

2. Applications

Flange static torque transmitters are devices created for the reaction wrench rilevation. Made in aluminium with capacity from 1 Nm to 10 Nm and in stainless steel with capacity from 20 Nm to 5000 Nm, represent the ideal solution for various applications such as the verification of torque wrenches, as they have the mechanical connection typically used by these tools.

3. Dimensions (mm.)

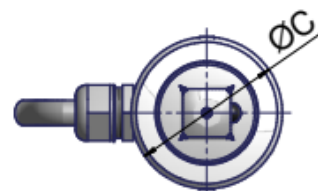
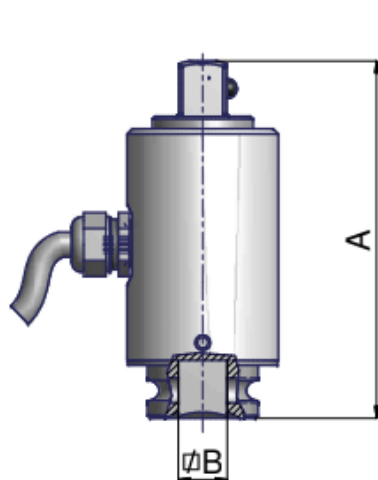

Portata Nm	A	B	C	Uscita mV	Std	OIML	ATEX
1 Nm	64	1/4"	20	0,5	✓		✓
2 - 5 - 10 Nm	64	1/4"	20	1	✓		✓
20 - 50 Nm	71	3/8"	30	1	✓		✓
100 Nm	76	1/2"	30	1	✓		✓
200 - 500 Nm	100	3/4"	49	1	✓		✓
1000 Nm	132	1"	64	1	✓		✓
2000 - 5000 Nm	250	1-1/12"	100	1	✓		✓

TORQUE TRANSMITTER

Torque load cell

4. Product features

Accuracy class	Standard
Capacities fs (Emax)	1÷5000 Nm
Rated output (Cn)	1 mV/V ± 0,5%
Nominal excitation range	5 ÷ 10V
Maximum excitation	15V
Zero balance output	± 1% fs
Input resistance	400 ± 25 Ω
Output resistance	350 ± 2 Ω
Insulation resistance	> 5 GΩ
Combined error	<± 0,2% fs
Non repeatability	<± 0,2% fs
Temperature effect on zero balance (5°C)	<± 0,02% fs
Temperature effect on rated output (5°C)	<± 0,02% fs
Compensated temperature range	-10°C ÷ +40°C
Operating temperature range	-15°C ÷ +70°C
Maximum safe load	150% fs
Ultimate load	>200/300% fs
Protection class (EN60529)	IP64
Torque load cell Material (1-10 Nm)	Aluminium
Torque load cell Material (20-5000 Nm)	Stainless steel
Safe-keeping Material	Aluminium
Cable lenght (1-10 Nm)	5m - 4 x 0,12 mm ²
Cable lenght (20-5000 Nm)	5m - 6 x 0,14 mm ²

5. Wire diagram

Torque load cell 1-10 Nm

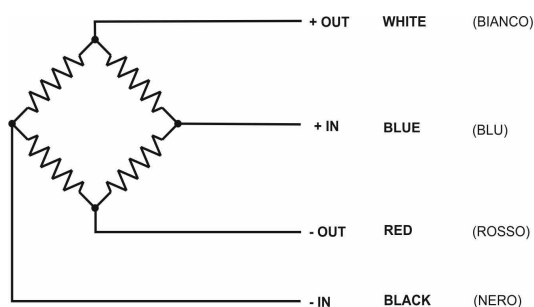

Torque load cell 20-5000 Nm

