

TP 2000

Pallet truck scale

1. Product description



- 1 Shock and vibration resistant
- 2 Water tight for outdoor use
- 3 Low power consumption
- 4 For checking incoming goods and shipping weights

2. Applications

The TP 2000 checks weights at goods reception or when filling out transport documents. A reliable asset in all industrial applications. Thanks to the robust chassis, the TP 2000 weighing hand pallet truck is suitable for basic and general day-to-day weighing needs. Being both shock and vibration resistant and water tight, makes this pallet scale most suitable for rough or outdoor conditions.

3. Dimensions (mm.)

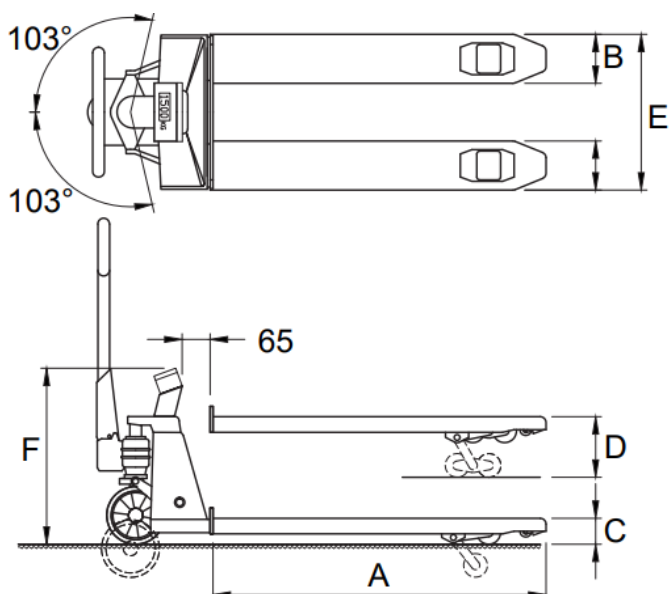

A	Fork length	1150
B	Fork width	180
C	Minimum fork height	85
D	Maximum fork height	200
E	Width over forks	555
F	Height to top indicator	600

TP 2000

Pallet truck scale

3. Product features

Division	1 kg
Weighing capacity	2000 kg
Display	LCD, digit height 18 mm
Keypad	3 function keys, on/off key
Protection class	Load cells IP67
	Indicator IP65
Steering wheels	Rubber
Loading wheels	Polyurethane, tandem
Colour	Red (RAL 3000), epoxy painted
Own weight	104 kg
Power supply	4 x 1.5V AA-batteries
Battery life	When used 5 times a day, the batteries last for a year
Pump	Quick lift

4. Software parameters

Automatic and manual zero correction
Gross/net weighing
Totalling with sequence number
Error messages in display
Automatic switch-off after 3 minutes of non-use
Low battery warning in display